

Two Bedroom Loft CM-C (Lower Level)

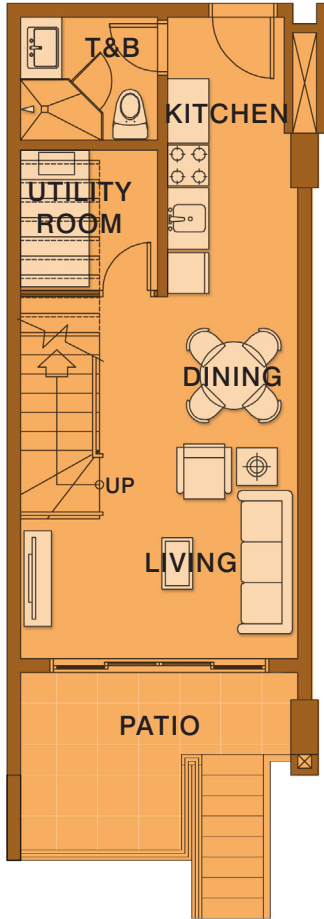

T&B	4.30	sqm
Utility	4.73	sqm
Stair Circulation	4.12	sqm
Kitchen	8.61	sqm
Dining	6.00	sqm
Living	13.04	sqm
Patio	12.36	sqm

Two Bedroom Loft CM-C (Upper Level)

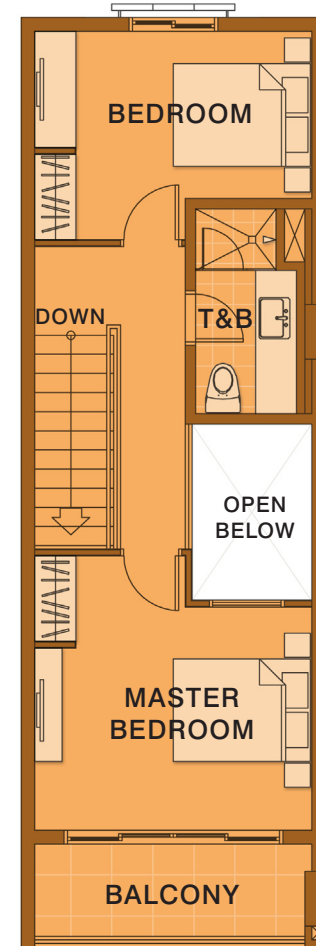

Stair Circulation	7.73	sqm
Master Bedroom	16.30	sqm
Master BR Balcony	6.80	sqm
Bedroom	12.52	sqm
T&B	5.91	sqm
TOTAL	102.42	sqm
	1,102.44	sq ft